



Features

The BT016 fuse terminal is made of copper with nickel or tin plated surface. It is mainly used for connections in electrical circuits. This specification refers to models BT016-080 and BT016-280.

- Material: copper H62, semi-hard
- Thickness: 0.8mm
- Pb- and Halogen-free, RoHS compliant
- Smooth Surface
- Soldering temperature: 260±5°C
- Bright tin plated (BT016-280); nickel plated (BT016-080)

Dimensions (unit in mm)

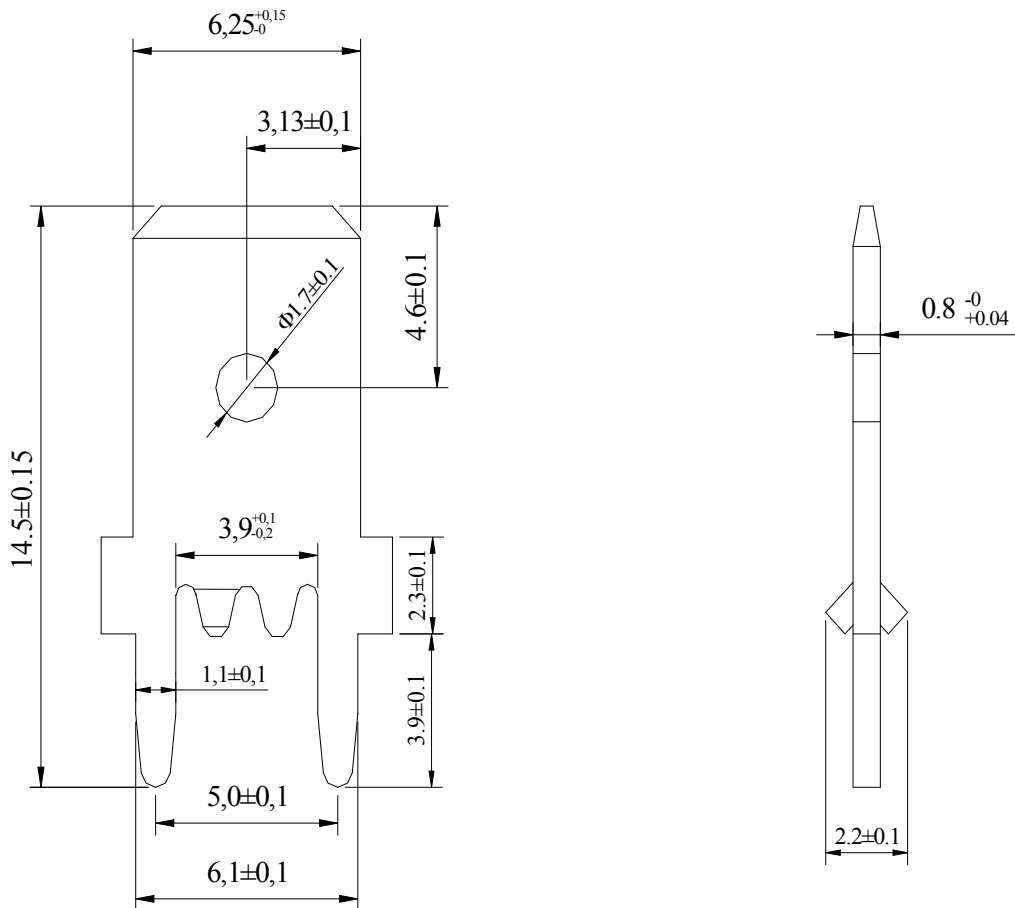

Ordering Information

Series	Part No.	Packaging Code	Qty
BT016			